

## **Appendix 6: Annex 4 - Preferred Options Indicative Layouts**

An indicative layout has been produced for each of the proposed new site allocations to give a visual representation of how development could take place. The layouts have been produced to help guide future site design work and show where the main policy requirements for each site could be located. The layouts will however act as a guide only and may be subject to change through the planning process.

**WEY14 - LAND AT WYKE OLIVER FARM (PREFERRED OPTION)**



© Crown Copyright and database right (2018). Ordnance Survey Licence number 100024307 (West Dorset District Council) and 100019690 (Weymouth and Portland Borough Council)



© Crown Copyright and database right (2018). Ordnance Survey Licence number 100024307 (West Dorset District Council) and 100019690 (Weymouth and Portland Borough Council)

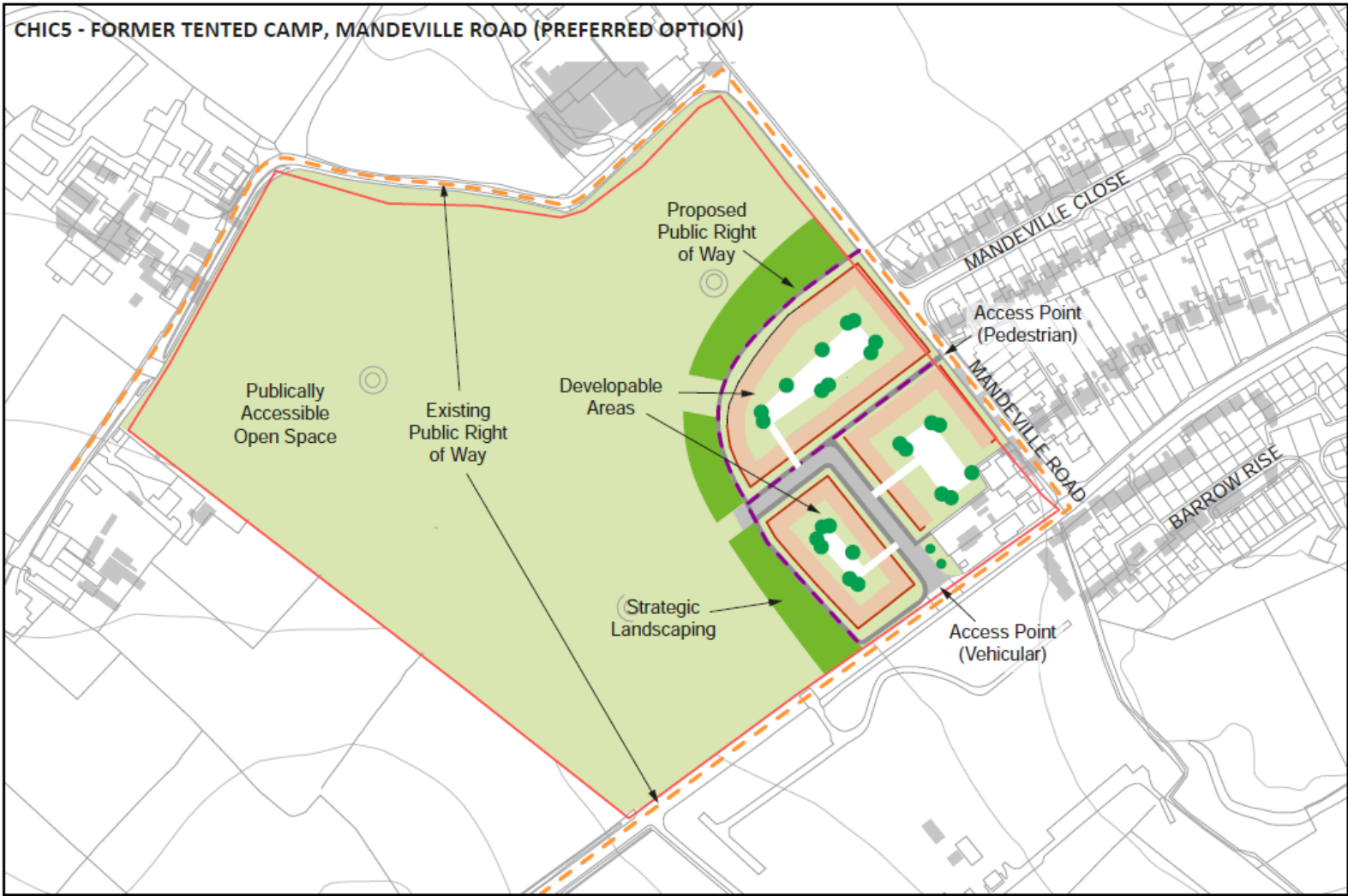

© Crown Copyright and database right (2018). Ordnance Survey Licence number 100024307 (West Dorset District Council) and 100019690 (Weymouth and Portland Borough Council)

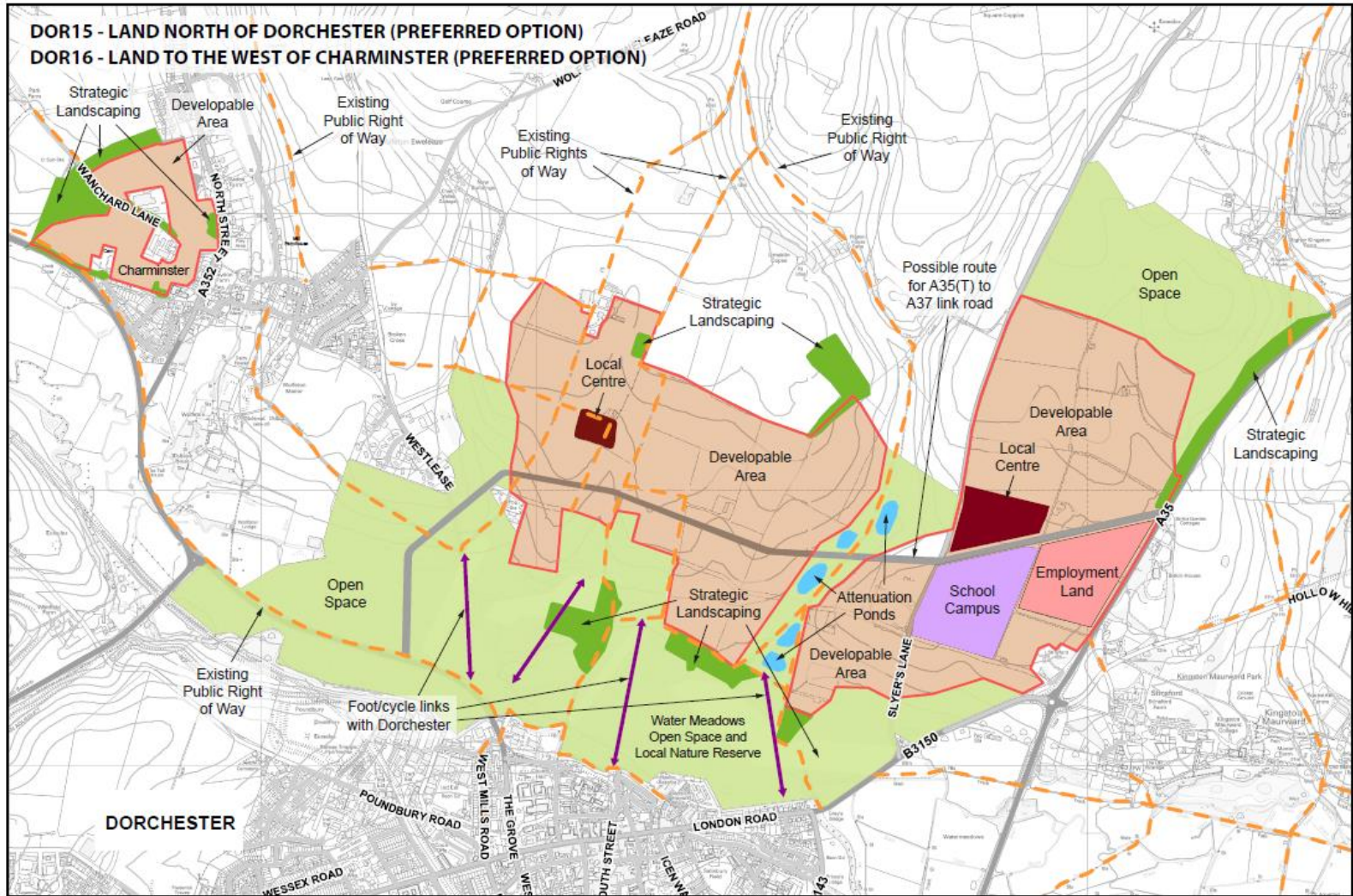

© Crown Copyright and database right (2018). Ordnance Survey Licence number 100024307 (West Dorset District Council) and 100019690 (Weymouth and Portland Borough Council)



**BEAM3 - LAND TO THE WEST OF TUNNEL ROAD (PREFERRED OPTION)**

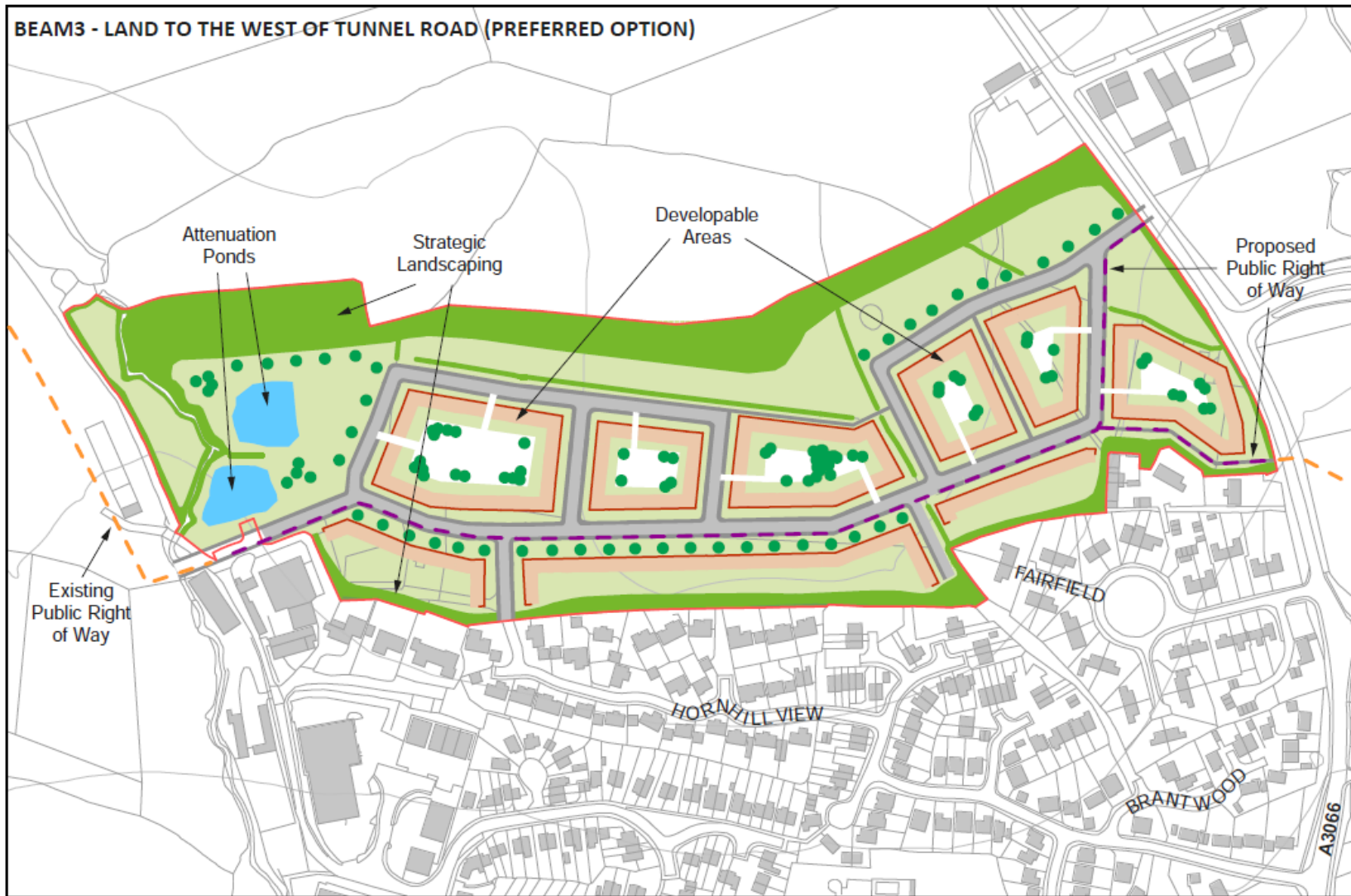

**BEAM4 - LAND TO THE SOUTH OF  
BROADWINDSOR ROAD (PREFERRED OPTION)**

